

- Apply White Lithium Grease (Do Not Use WD40 or another oil) wherever metal parts rub together. Below are some generic mechanisms however your mechanism may be different. Operate the mechanism to distribute the grease throughout the joints. You can also apply white lithium grease to rocker springs (NOT SHOWN).

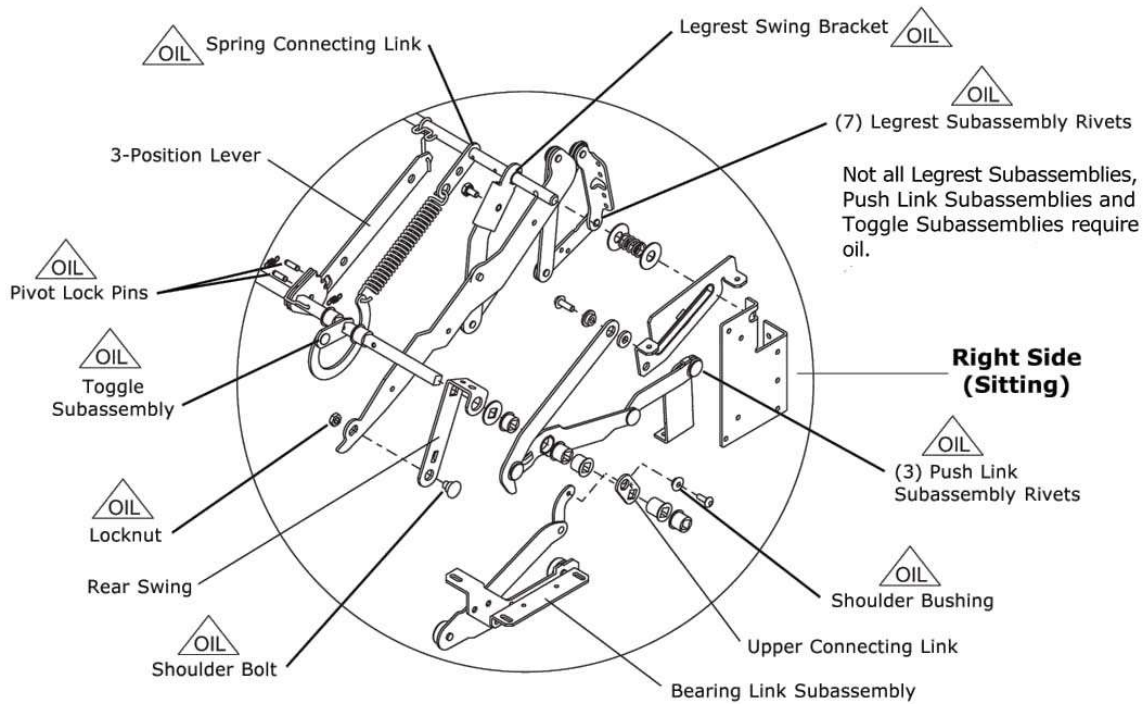

Note: Where above picture says "Oil" use White Lithium Grease, NOT another kind of oil.

